

NOTE: WHEN CURB EXISTS ALONG THE COUNTY ROADWAY, THE PROPOSED CURB LINE SHALL EXTEND ALONG THE LENGTH OF TAPER TO THE END OF THE EXISTING CURB, BOTH HORIZONTALLY AND VERTICALLY.

FIGURE 500-07 MORRIS COUNTY TYPICAL DETAIL PAVEMENT TAPER NOT TO SCALE 5/2011 MOC

PAVEMENT TAPER (PLAN VIEW)

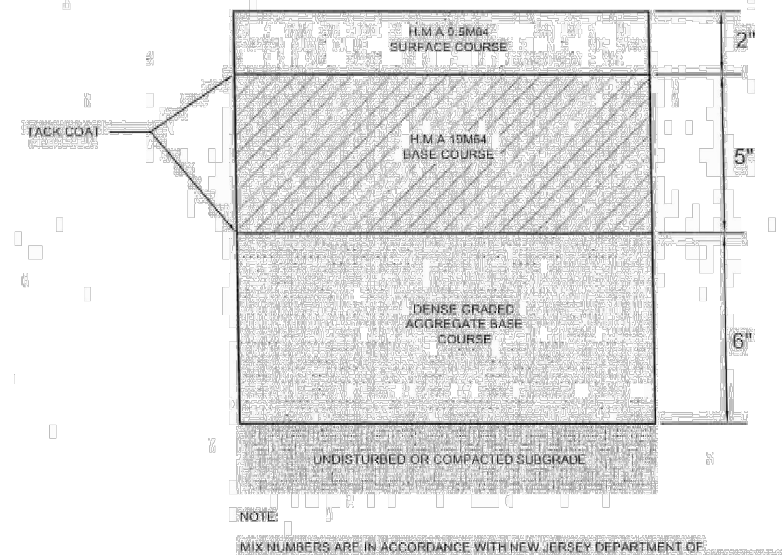

NOTE: MINIMUM TOLERANCE IS ACCORDANCE WITH NEW JERSEY DEPARTMENT OF TRANSPORTATION STANDARD SPECIFICATIONS FOR ROAD AND BRIDGE CONSTRUCTION (2011) TABLE 203-1.

FIGURE 500-06 MORRIS COUNTY TYPICAL DETAIL HMA PAVEMENT DETAIL NOT TO SCALE 07-08 DD

HMA PAVEMENT DETAIL

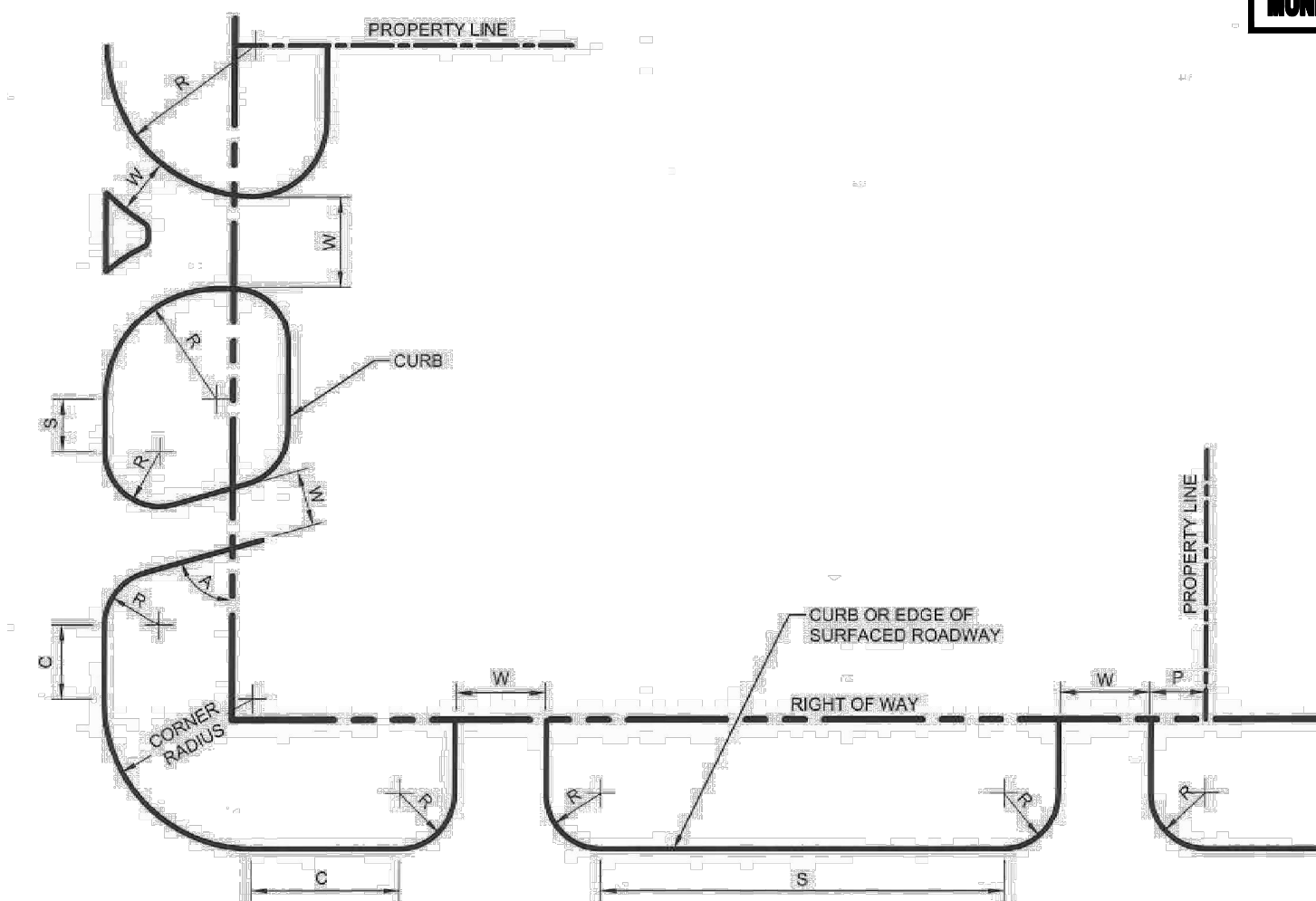

FIGURE 500-01 MORRIS COUNTY TYPICAL DETAIL DRIVEWAY LOCATION DIAGRAM NOT TO SCALE 5/2011 MOC

DRIVEWAY LOCATION DIAGRAM

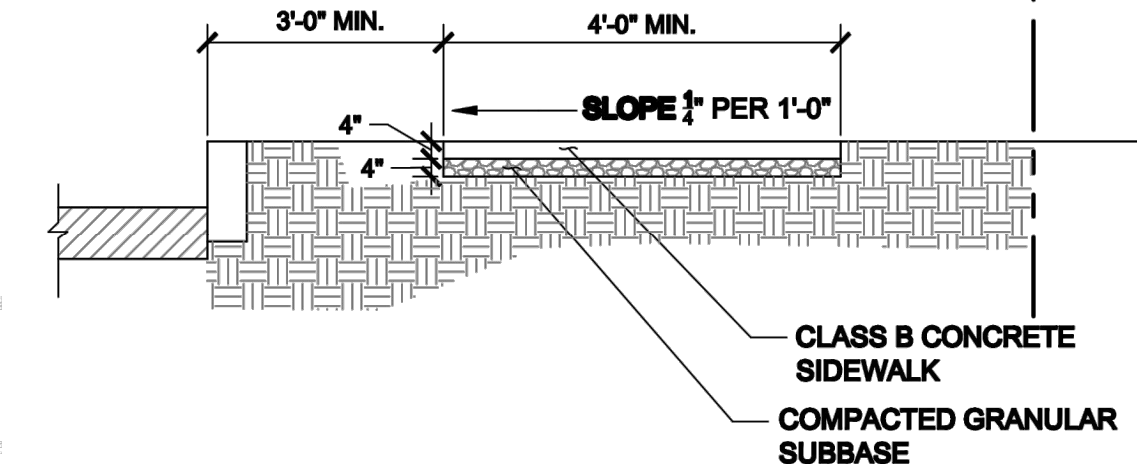
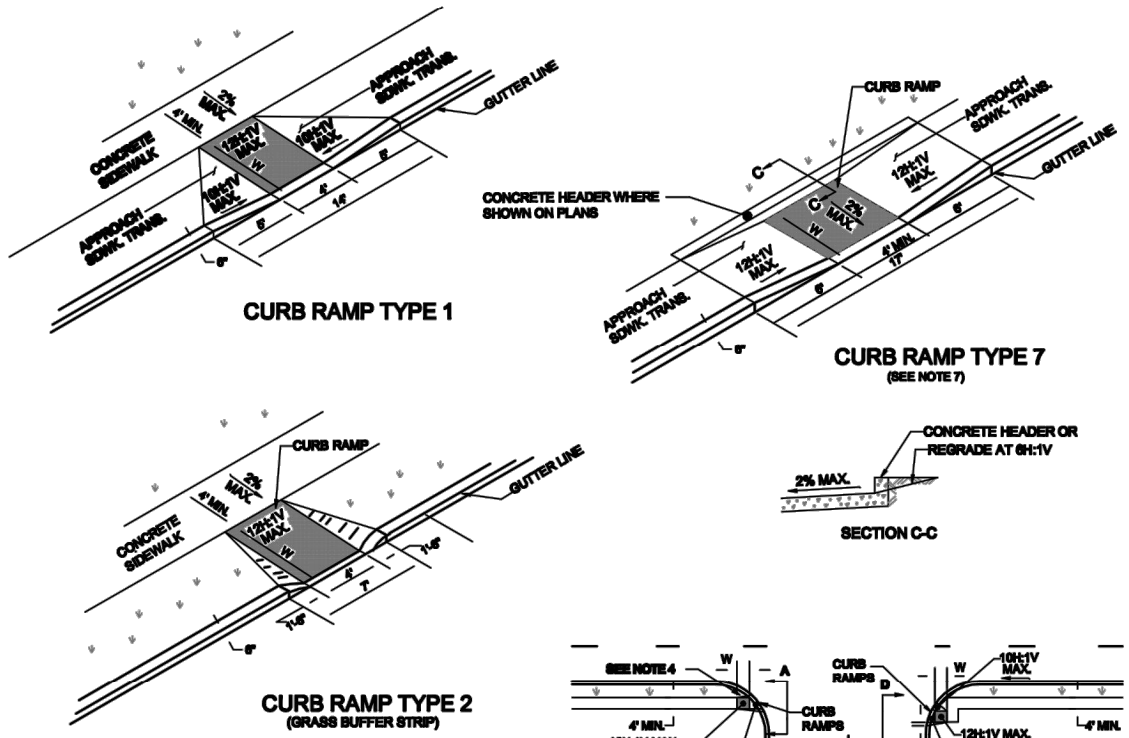

FIGURE 500-12 MORRIS COUNTY TYPICAL DETAIL CONCRETE SIDEWALK NOT TO SCALE 9-1-08 DD

CONCRETE SIDEWALK



GENERAL NOTE: 1. LANDING AREA APPROACHING SIDEWALK TRANSITIONS, AND CURB RAMP SHALL BE LEFT UNPAVED UNLESS OTHERWISE NOTED. 2. CURB RAMP SHALL BE CONSTRUCTED WITH A MINIMUM 2% SLOPE. 3. CURB RAMP SHALL BE CONSTRUCTED WITH A MINIMUM 2% SLOPE. 4. CURB RAMP SHALL BE CONSTRUCTED WITH A MINIMUM 2% SLOPE.

FIGURE 500-13 MORRIS COUNTY TYPICAL DETAIL CURB RAMP DETAIL NOT TO SCALE 9-1-08 DD

CURB RAMP DETAIL

LOCATION OF CURB RAMP TYPES 1, 2, 3, 4 & 7 FOR CROSSING PARALLEL AND PERPENDICULAR TO HIGHWAY

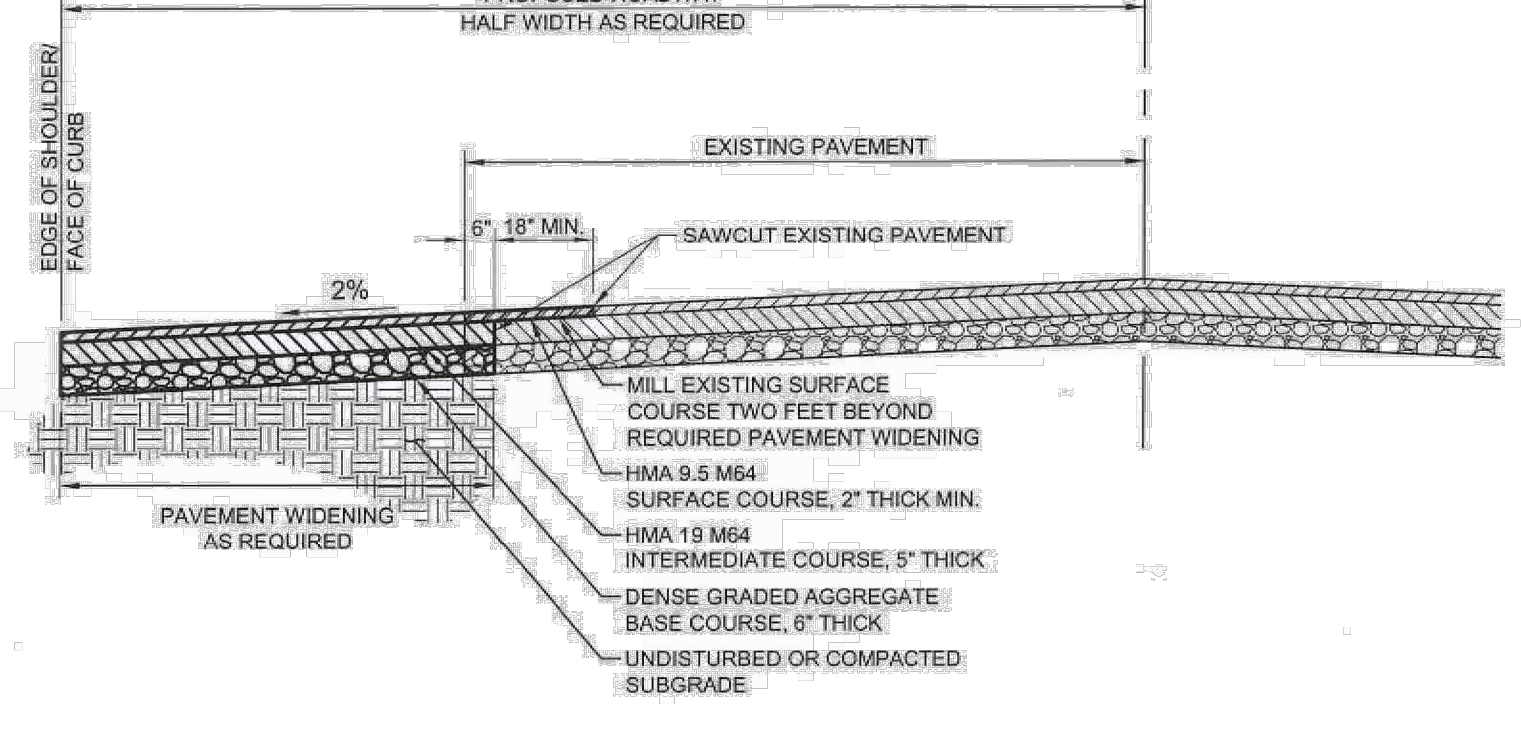

FIGURE 500-04 MORRIS COUNTY TYPICAL DETAIL PAVEMENT WIDENING SECTION (P3%) NOT TO SCALE 5/2011 MOC

EXISTING PAVEMENT WIDENING (ROADWAY CROSS SLOPE LESS THAN 3%)

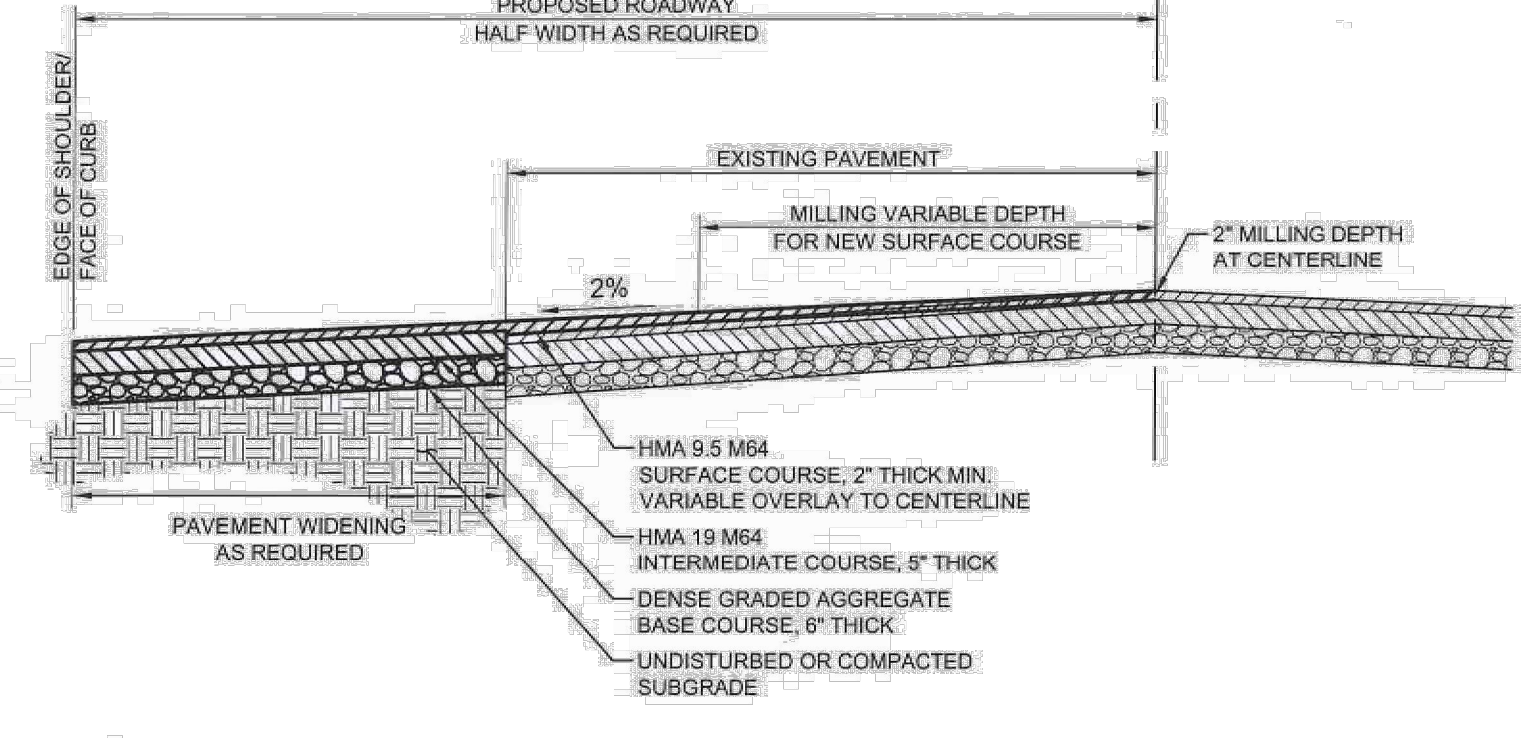

FIGURE 500-05 MORRIS COUNTY TYPICAL DETAIL PAVEMENT WIDENING SECTION (P3%) NOT TO SCALE 5/2011 MOC

EXISTING PAVEMENT WIDENING CROSS-SECTION (ROADWAY CROSS SLOPE EXCEEDING 3%)

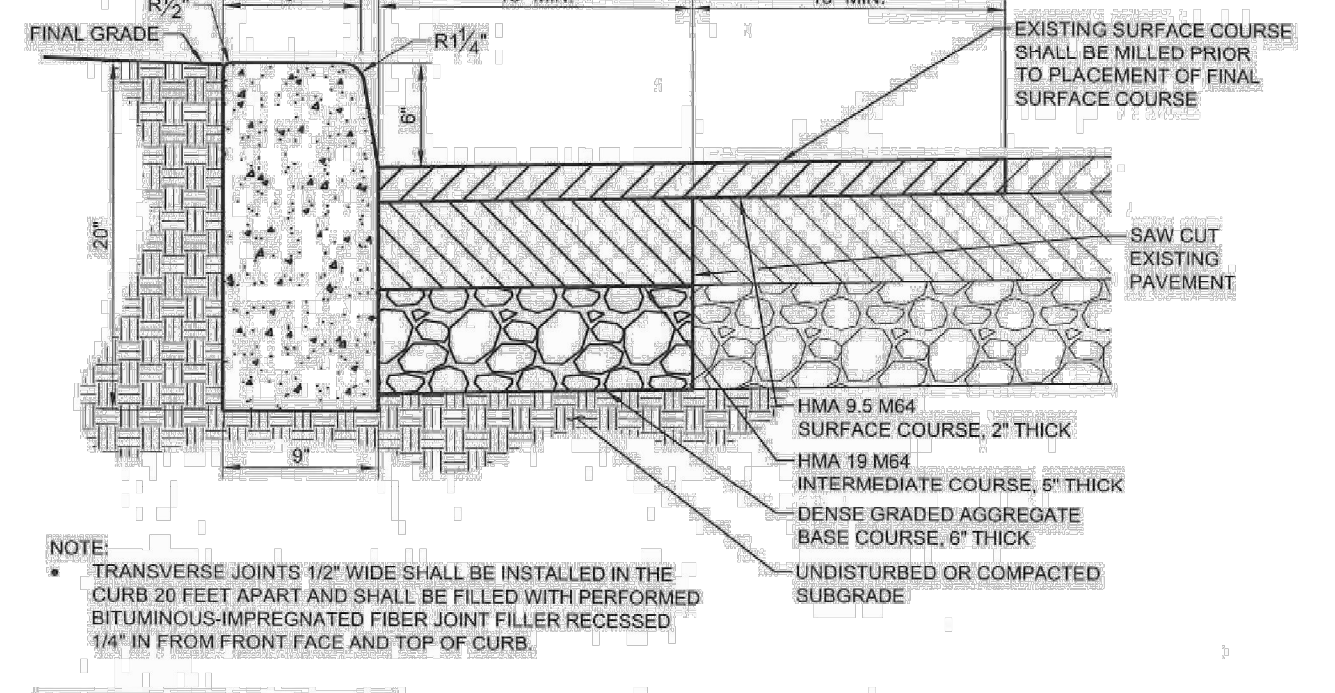

FIGURE 500-10 MORRIS COUNTY TYPICAL DETAIL CONCRETE CURB DETAIL NOT TO SCALE 5/2011 MOC

CONCRETE CURB DETAIL

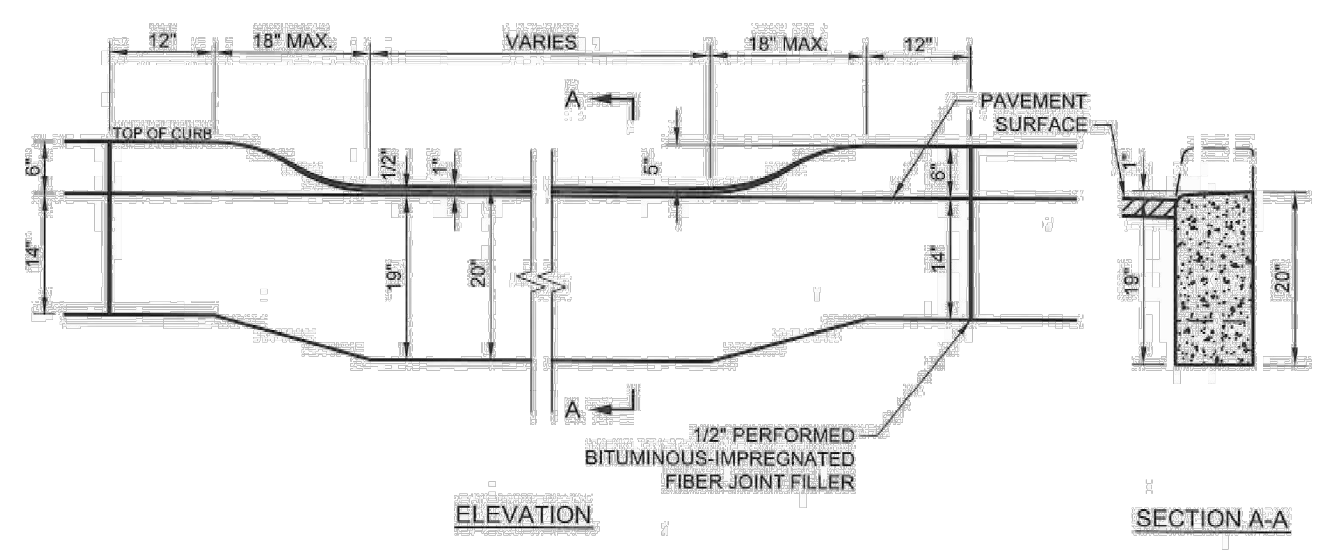

FIGURE 500-11 MORRIS COUNTY TYPICAL DETAIL DEPRESSED CONCRETE CURB DETAIL NOT TO SCALE 5/2011 MOC

DEPRESSED CONCRETE CURB DETAIL

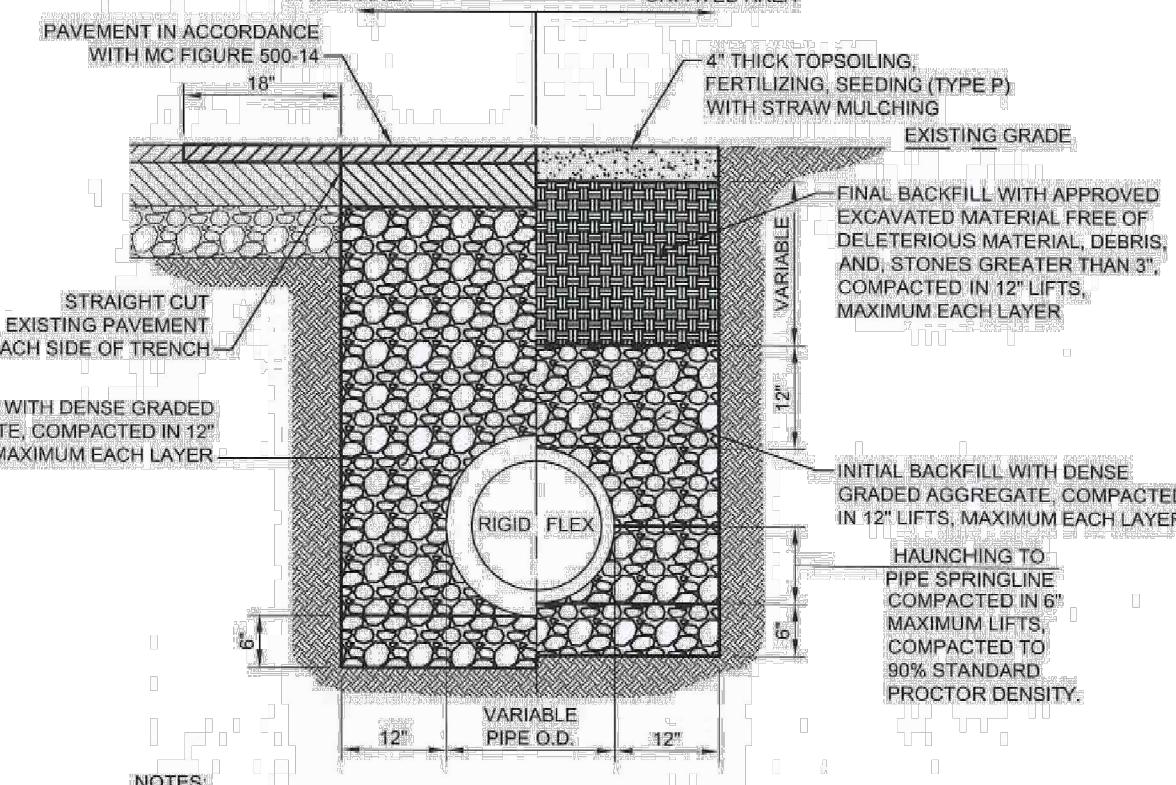

FIGURE 500-15 MORRIS COUNTY TYPICAL DETAIL TRENCH DETAIL NOT TO SCALE 5/2011 MOC

TRENCH DETAIL

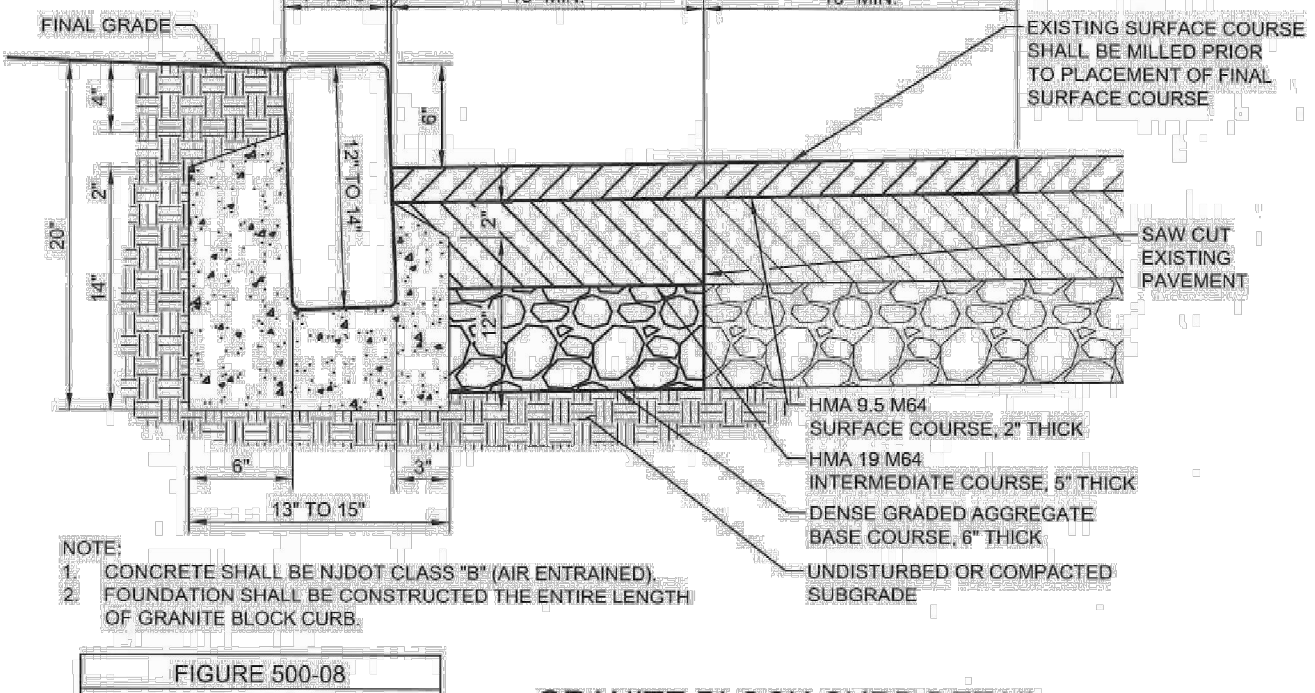

FIGURE 500-08 MORRIS COUNTY TYPICAL DETAIL GRANITE BLOCK CURB DETAIL NOT TO SCALE 5/2011 MOC

GRANITE BLOCK CURB DETAIL

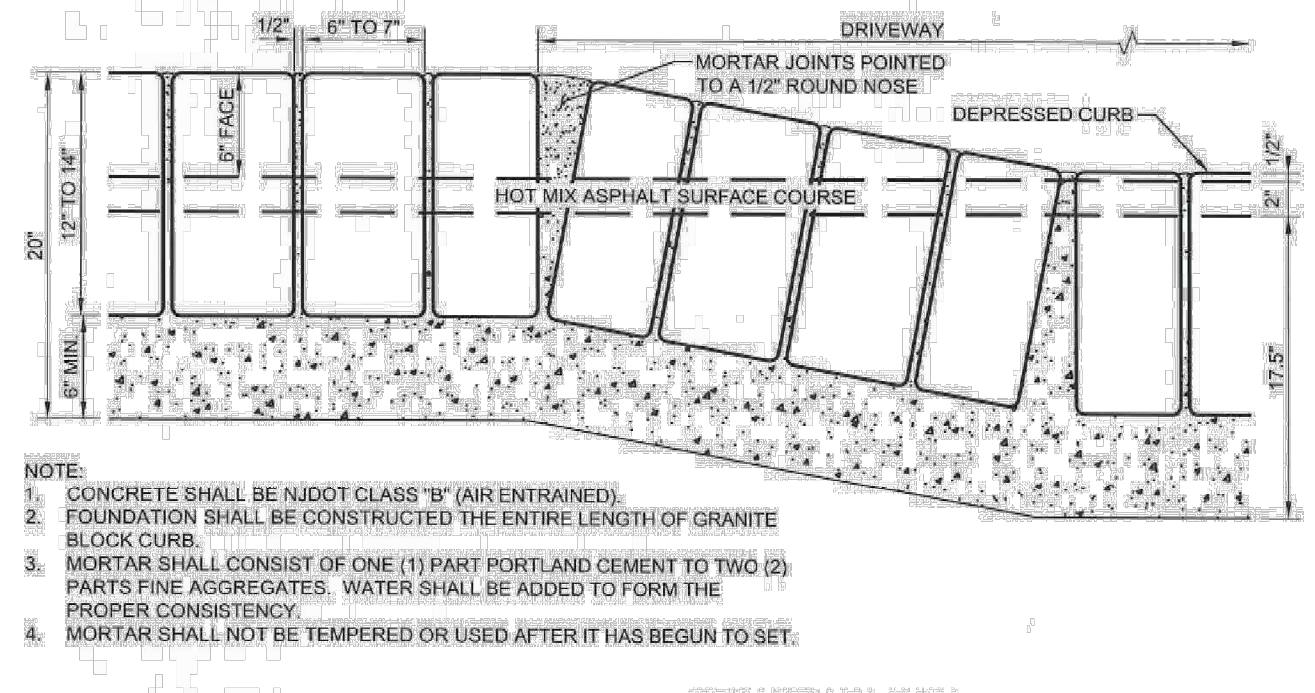

FIGURE 500-09 MORRIS COUNTY TYPICAL DETAIL GRANITE BLOCK DEPRESSED CURB DETAIL NOT TO SCALE 5/2011 MOC

GRANITE BLOCK DEPRESSED CURB DETAIL

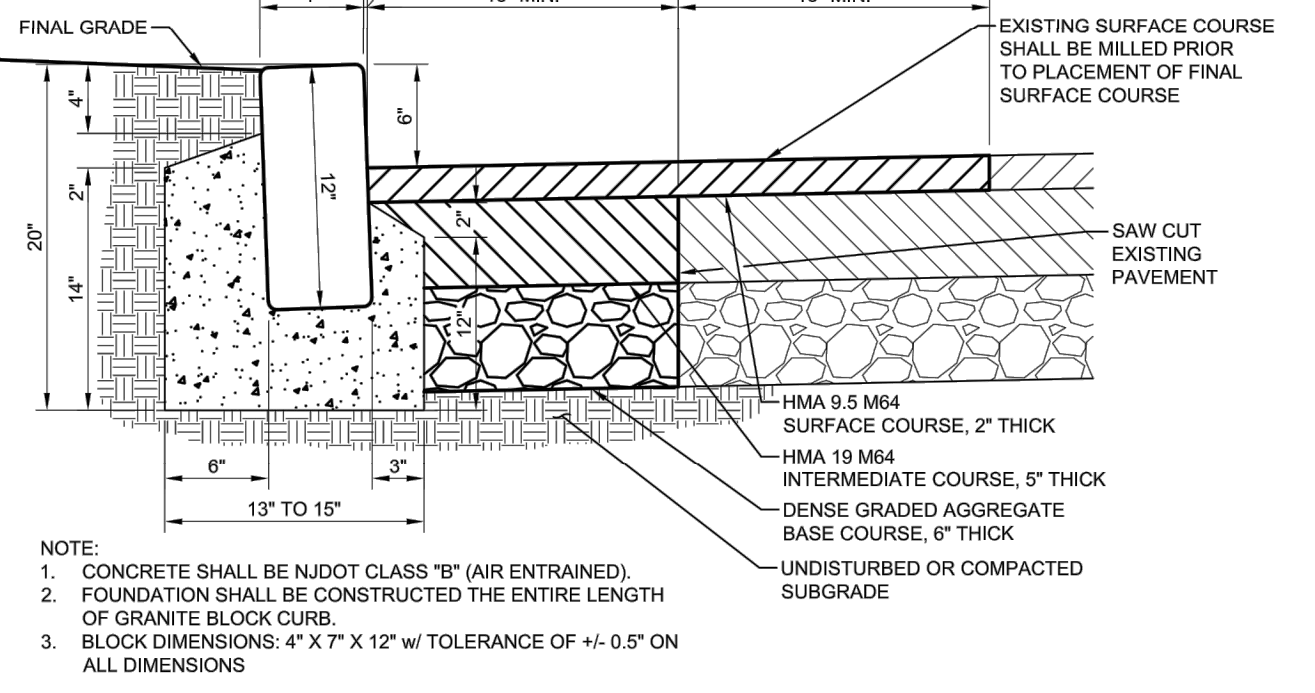

FIGURE 500-08 MORRIS COUNTY TYPICAL DETAIL GRANITE BLOCK CURB DETAIL NOT TO SCALE 12/2019 WMM

GRANITE BLOCK CURB DETAIL

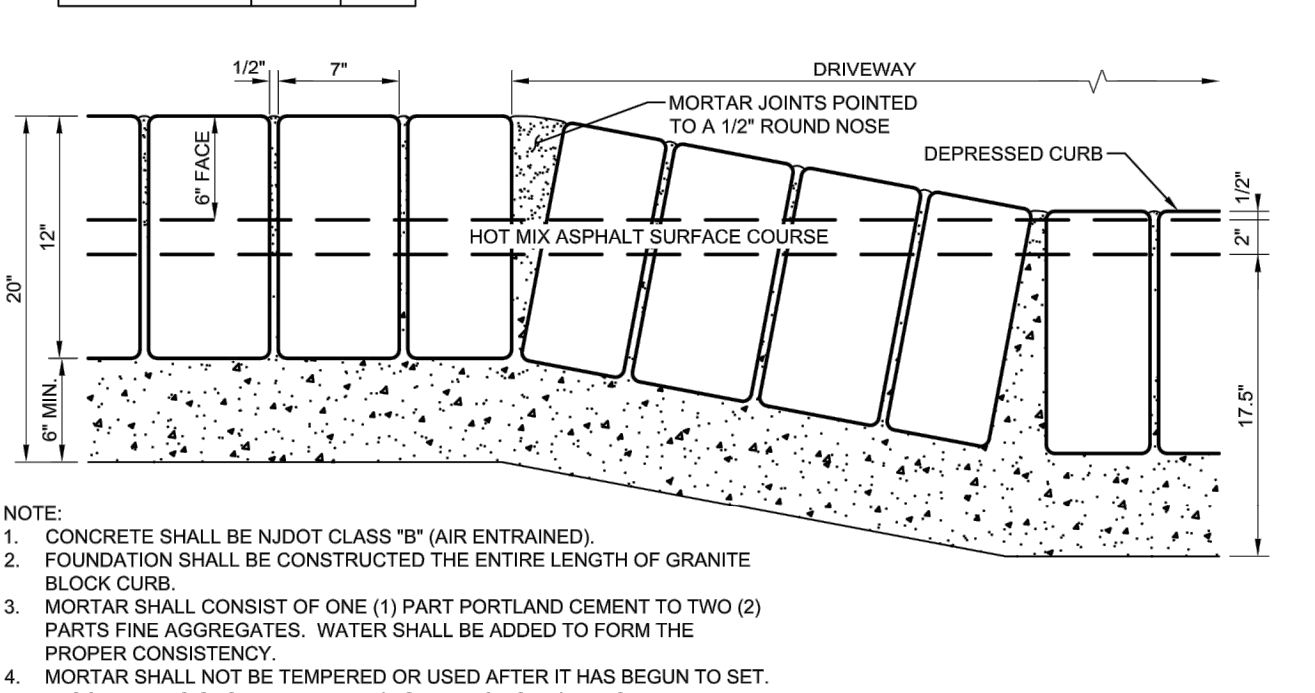

FIGURE 500-09 MORRIS COUNTY TYPICAL DETAIL GRANITE BLOCK DEPRESSED CURB DETAIL NOT TO SCALE 12/2019 WMM

GRANITE BLOCK DEPRESSED CURB DETAIL

Plotted: 08/07/20 10:50 AM, By: ejiwright, File: \\dpc\local\deciders\data\DECPC PROJECTS\0555 Elite Properties\09-010 Long Hill\Draw Site Plans\055599010500.dwg, -----> 20 MORRIS COUNTY DETAILS

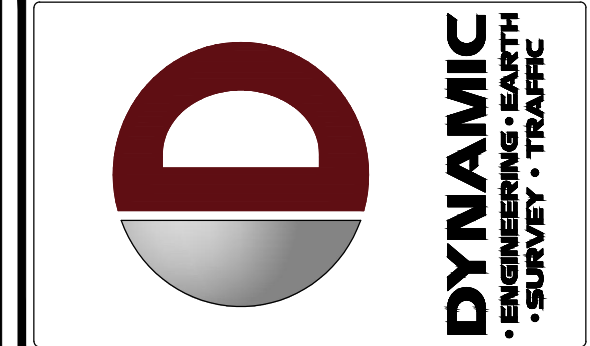

Table with columns: NO., DATE, COMMENTS, REV. Includes revision table with empty rows.

Table with columns: THIS PLAN SET IS FOR PERMITTING PURPOSES ONLY AND MAY NOT BE USED FOR CONSTRUCTION, DRAWN BY, CHECKED BY, DESIGNED BY, PROJECT: ELITE PROPERTIES PROPOSED RESIDENTIAL DEVELOPMENT, BLOCK 10801, LOT 3, 62A VALLEY ROAD (C.R. 512), TOWNSHIP OF LONG HILL, MORRIS COUNTY, NEW JERSEY.

811 PROTECT YOURSELF. ALL STATES REQUIRE NOTIFICATION OF EXISTING UTILITIES, DESIGNERS, OR ANY PERSON BEFORE TO BEGIN THE EARLY SURFACE WORK IN ANY STATE. FOR STATE SPECIFIC DIRECT PHONE NUMBERS VISIT: WWW.CALL811.COM

DYNAMIC ENGINEERING LAND DEVELOPMENT CONSULTING • PERMITTING, GEOTECHNICAL • ENVIRONMENTAL, TRAFFIC • SURVEY • PLANNING & ZONING. 245 Main Street, Suite 110, Chester, NJ 07930. 1: 908.879.9229 | F: 908.879.0222. Offices conveniently located at: Clark, NJ; Chester, NJ; Newark, NJ; Trenton, NJ; Philadelphia, PA; Allentown, PA; York, PA; Harrisburg, PA; Baltimore, MD; Washington, DC; Miami, FL; Orlando, FL; Tampa, FL; Jacksonville, FL; Fort Lauderdale, FL; Miami Beach, FL; Boca Raton, FL; West Palm Beach, FL; Ft. Myers, FL; Sarasota, FL; Naples, FL; Venice, FL; Venice Beach, FL; Delray Beach, FL; Palm Beach, FL; Palm Springs, FL; Palm Jumeirah, UAE; Dubai, UAE; Abu Dhabi, UAE; Riyadh, Saudi Arabia; Doha, Qatar; Kuwait City, Kuwait; Amman, Jordan; Beirut, Lebanon; Tel Aviv, Israel; Haifa, Israel; Jerusalem, Israel; Cairo, Egypt; Addis Ababa, Ethiopia; Nairobi, Kenya; Kampala, Uganda; Addis Ababa, Ethiopia; Nairobi, Kenya; Kampala, Uganda; Addis Ababa, Ethiopia; Nairobi, Kenya; Kampala, Uganda.

JOSEPH G. JAWORSKI PROFESSIONAL ENGINEER NEW JERSEY LICENSE NO. 36618

BRETT W. SKAPINETZ PROFESSIONAL ENGINEER NEW JERSEY LICENSE NO. 41985

MORRIS COUNTY DETAILS

SCALE: (H) AS SHOWN DATE: 08/07/2020 PROJECT No: 0555-99-010 SHEET No: 20 OF 21

THIS PLAN TO BE UTILIZED FOR VEHICLE CIRCULATION PURPOSES ONLY

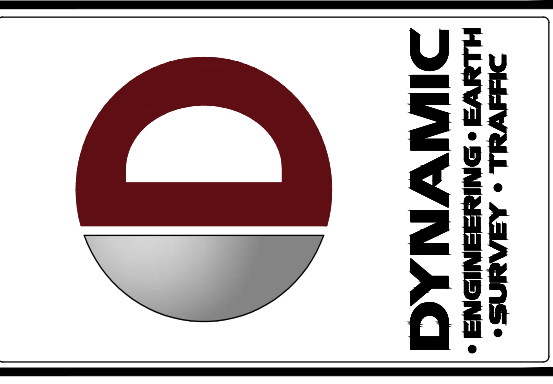

REV.	DATE	COMMENTS

THIS PLAN SET IS FOR PERMITTING PURPOSES ONLY AND MAY NOT BE USED FOR CONSTRUCTION	
DRAWN BY: A/LW CHECKED BY: JGSJ REVISION BY: WEB	PROJECT: ELITE PROPERTIES PROPOSED RESIDENTIAL DEVELOPMENT BLOCK 10801, LOT 3 624 VALLEY ROAD (CR. 512) TOWNSHIP OF LONG HILL, MORRIS COUNTY, NEW JERSEY

811 PROTECT YOURSELF
 ALL STATES REQUIRE NOTIFICATION OF EXCAVATORS, DESIGNERS, OR ANY PERSON PREPARING TO DIGGING THE EARTH'S SURFACE ANYWHERE IN ANY STATE
 FOR STATE SPECIFIC DIRECT PHONE NUMBERS VISIT: WWW.CALL811.COM

DYNAMIC ENGINEERING
 LAND DEVELOPMENT CONSULTING • PERMITTING
 GEOTECHNICAL • ENVIRONMENTAL
 TRAFFIC • SURVEY • PLANNING & ZONING
 245 Main Street, Suite 110
 Chester, NJ 07930
 T: 908.879.9229 | F: 908.879.0222
 Offices conveniently located at:
 Oak Ridge, New Jersey • 1-201-941-0176
 Newark, New Jersey • 1-973-750-7200
 Fort Mill, New Jersey • 1-732-374-0700
 Newtown, Pennsylvania • 1-867-685-0276
 Allen, Texas • 1-972-354-2100
 Houston, Texas • 1-281-981-6400
 Fort Worth, Texas • 1-817-346-2945
 Delray Beach, Florida • 1-561-921-8570
www.dynamiccec.com

JOSEPH G. JAWORSKI
 PROFESSIONAL ENGINEER
 NEW JERSEY LICENSE NO. 36618

BRETT W. SKAPINETZ
 PROFESSIONAL ENGINEER
 NEW JERSEY LICENSE NO. 41985

TITLE: **VEHICLE CIRCULATION PLAN (FIRE TRUCK)**

SCALE: (H) 1" = 30'
 (V) 1" = 30'
 PROJECT No: 0555-99-010
 SHEET No: 21
 DATE: 06/07/2020
 Rev. #:

21 OF 21

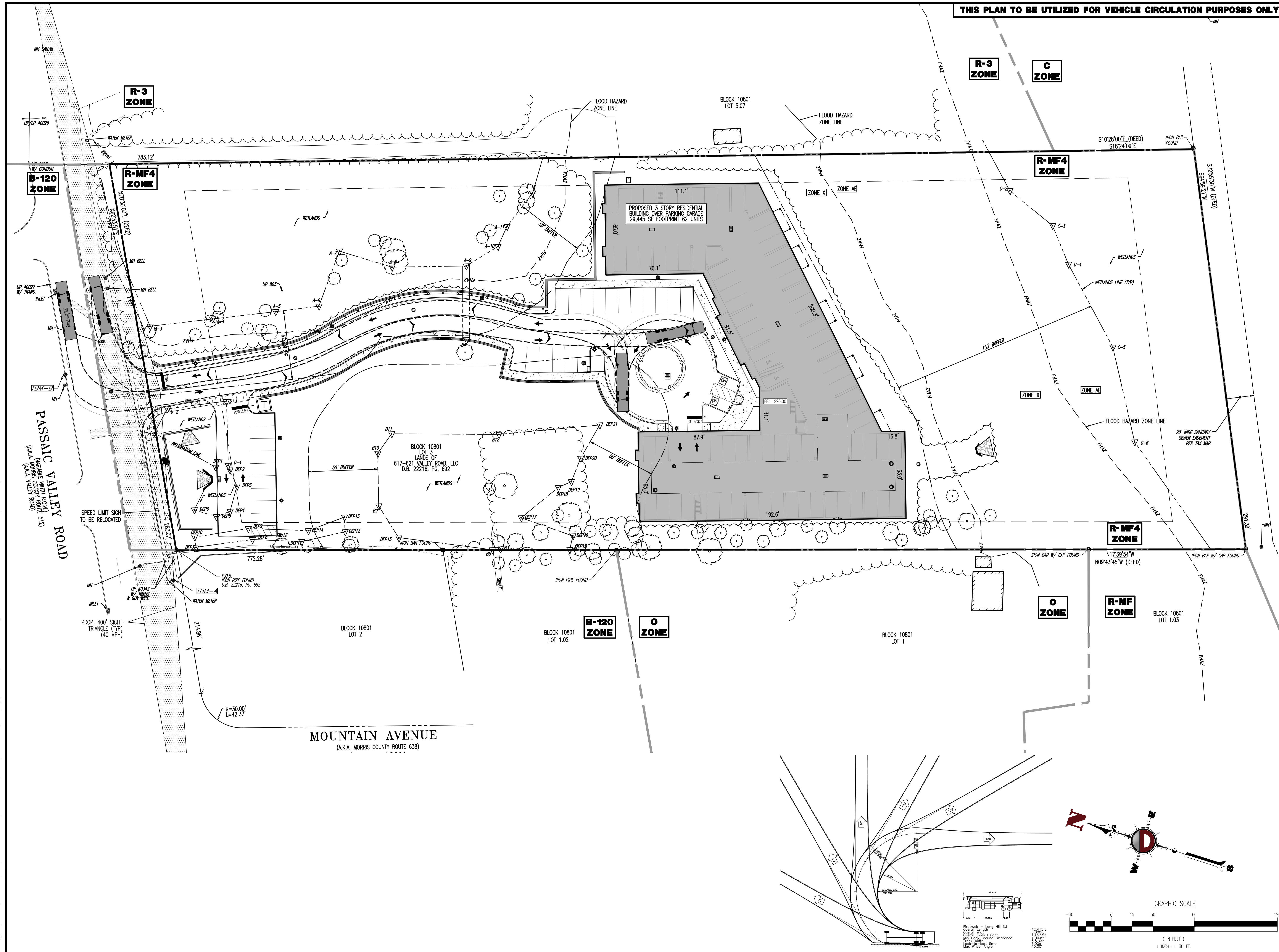

Plotted: 06/07/20 10:50 AM, By: ejwright
 File: \\deeplocal\desig\clients\0555 Elite Properties\09-010 Long Hill\Dwg\Site Plans\055599010SV0.dwg
 Plot: 21 VEHICLE CIRCULATION PLAN (FIRE TRUCK)